

Land Registry Official copy of title plan

Title number **WSX321154**
Ordnance Survey map reference **TQ0717NW**
Scale **1:2500**
Administrative area **West Sussex: Horsham**

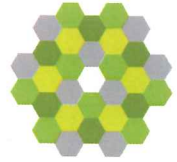

© Crown Copyright. Produced by Land Registry. Reproduction in whole or in part is prohibited without the prior written permission of Ordnance Survey. Licence Number 100026316.

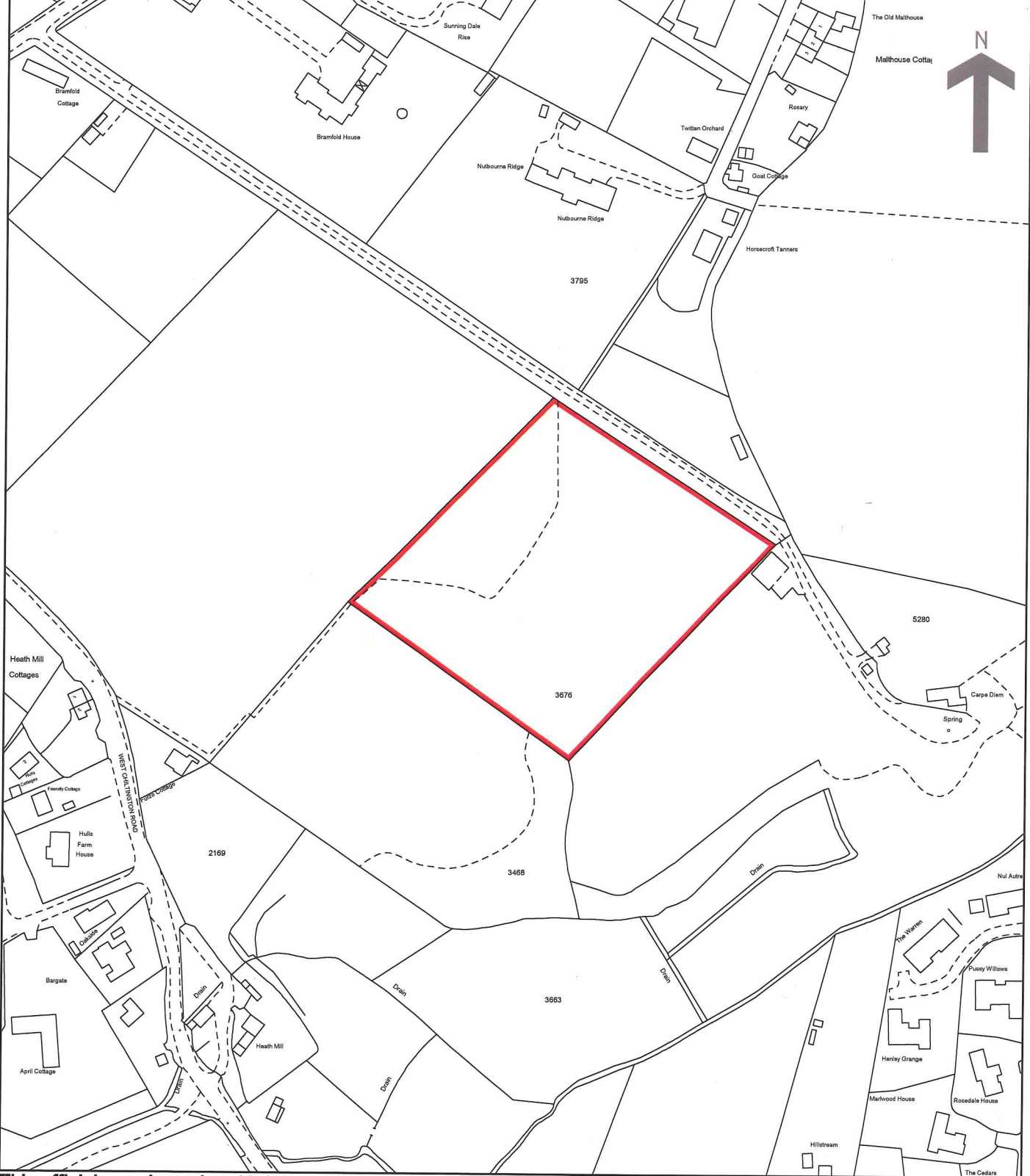

This official copy issued on 29 July 2008 shows the state of this title plan on 29 July 2008 at 09:21:00. It is admissible in evidence to the same extent as the original (s.67 Land Registration Act 2002).

This title plan shows the general position, not the exact line, of the boundaries. It may be subject to distortions in scale. Measurements scaled from this plan may not match measurements between the same points on the ground. See Land Registry Public Guide 19 - Title Plans and Boundaries.

This title is dealt with by Land Registry, Portsmouth Office.